

REVISIONS			
NO	DESCRIPTION	APPROVED	DATE

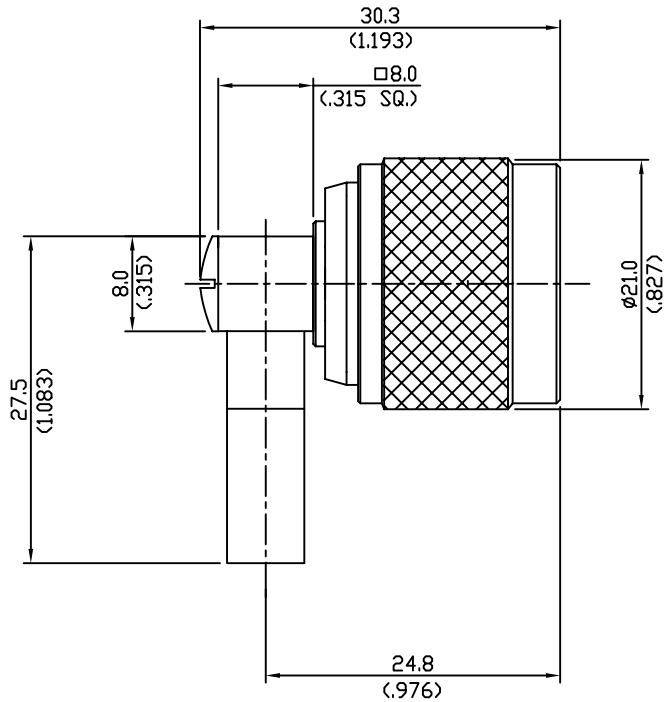

Impedance.....50Ω
 Frequency range.....DC ~ 11GHz
 V.S.W.R.....N/A
 Dielectric withstanding
 - Voltage(at sea level).....2500Vrms.50Hz
 - Working voltage(at sea level)..... ≤ 1000Vrms.50Hz
 Insulation resistance..... ≥ 5.10⁻³ MΩ
 Center contact resistance..... ≤ 1.0MΩ
 Out contact resistance..... ≥ 1.0MΩ
 Temperature range..... -65°C ~ +165°C
 Temperature shock..... MIL-STD202, Method107, ConditionB
 Moisture resistance..... MIL-STD202, Method106
 Corrosion..... Saltspray Test acc.to MIL-STD-202, Method101, ConditionB
 Vibration..... MIL-STD202, Method204, ConditionB
 Shock..... MIL-STD202, Method213, ConditionI
 Coupling nut torque
 - Recommended torque....0.68Nm~1.13Nm/6.0~10.0in.-lbs
 - Coupling proof torque....1.70Nm/15.0in.-lbs
 Coupling retention force..... ≥ 450N/101.2lbs.
 Contact captivation..... ≥ 28N/6.3lbs.
 Durability(Matings)..... ≥ 500

Connector parts	Material	Plating
Bodys	Brass	Nickel
Cente contact	Brass	Gold
Insulator	PTFE	White

TOL.UNLESS NOTED
 X = ±0.1
 X.X = ±0.05
 X.XX = ±0.01

DATE	
DRAWN BY	
DESIGNED BY	
CHECKED BY	
APPD.BY	
SCALE 1 : 1	UNIT mm

RFAC Solutions www.rfacsolutions.com

TITLE N RIGHT ANGEL PLUG
 RG-400. 142. 223. 58 (Fig1)

DRAWING NO R380-017-000

SHEET 1 OF 1